

# Repair Parts

116.598.AB.4

HyTronic Traditional Sink Faucet with Dual Beam Infrared Sensor

# CHICAGO FAUCETS®

Geberit Group

HyTronic Base, No Mixer

## Base Parts:

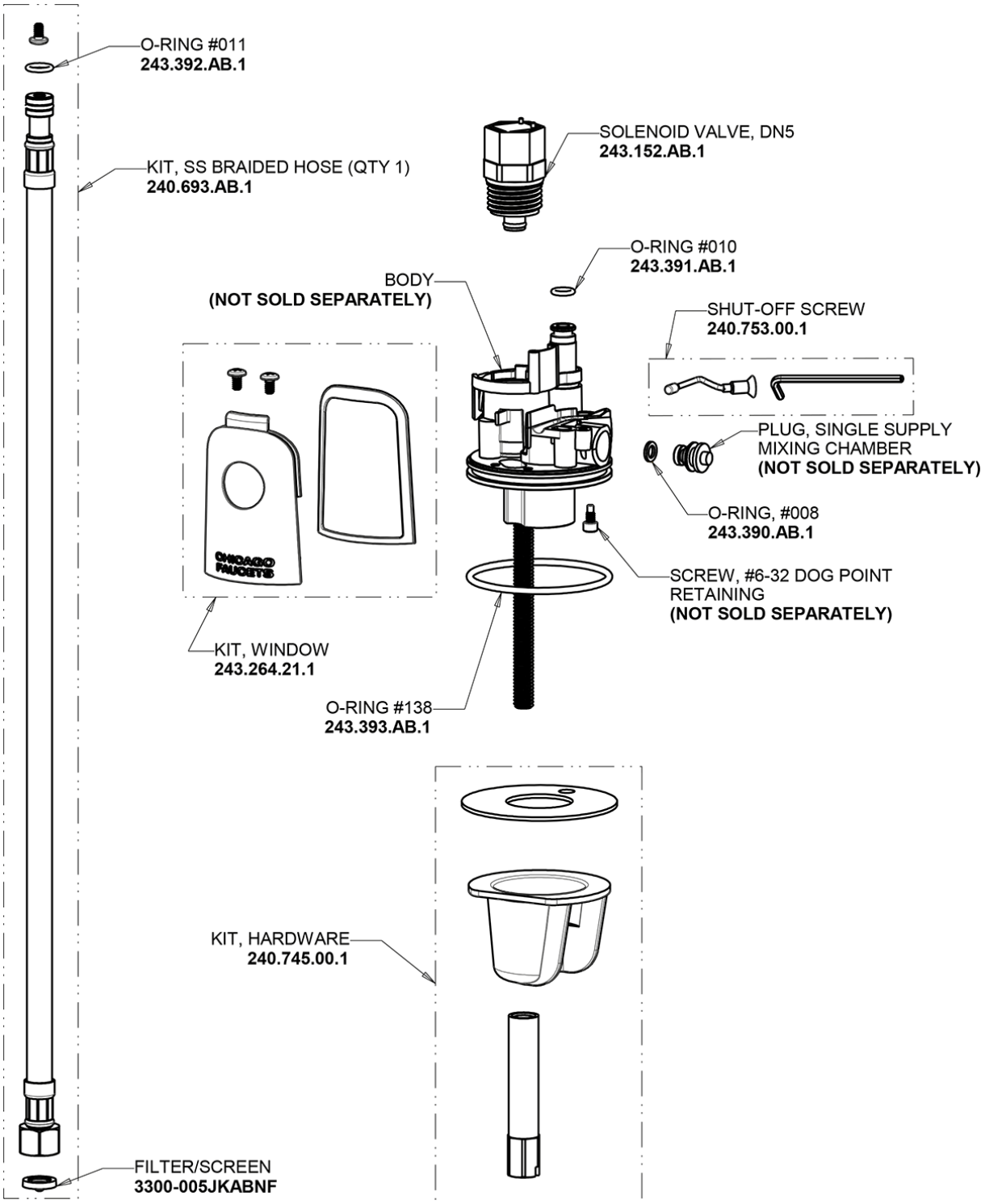

## For Technical Assistance:

Phone: 800-TEC-TRUE (832-8783)

Email: [techsupport.us@chicagofaucets.com](mailto:techsupport.us@chicagofaucets.com)

2100 South Clearwater Drive

Des Plaines, IL 60018

Phone: 847-803-5000

[chicagofaucets.com](http://chicagofaucets.com)

# Repair Parts

116.598.AB.4

HyTronic Traditional Sink Faucet with Dual Beam Infrared Sensor

# CHICAGO FAUCETS®

Geberit Group

HyTronic Traditional Spout  
240.724.AB.1

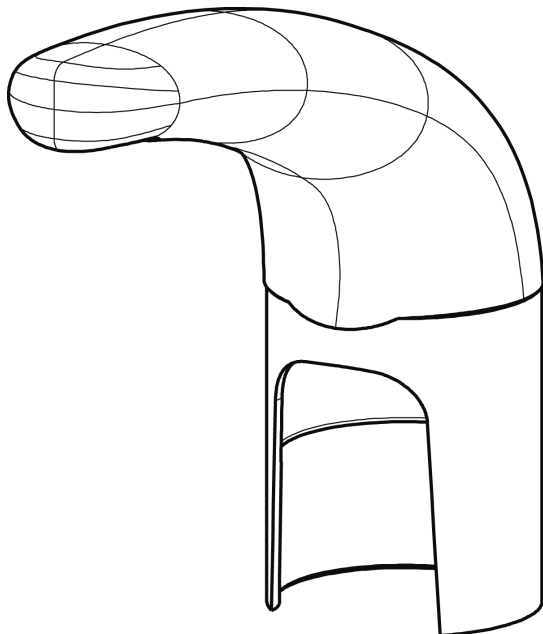

CHECK-CARTRIDGE  
550-009KJKABNF



O-RING, #010  
243.391.AB.1



0.35 GPM (1.3 L/min) Vandal Proof Econo-Flo Non-Aerating  
Outlet  
E39VPJKABCP

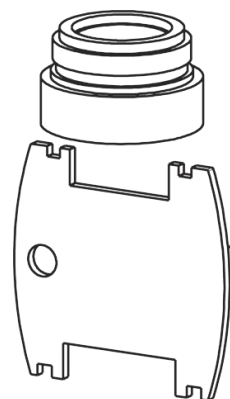

VANDAL PROOF KEY  
3-024JKRCF

Long Life Battery Kit  
243.868.00.1



ADAPTER (GREEN)  
242.568.00.1

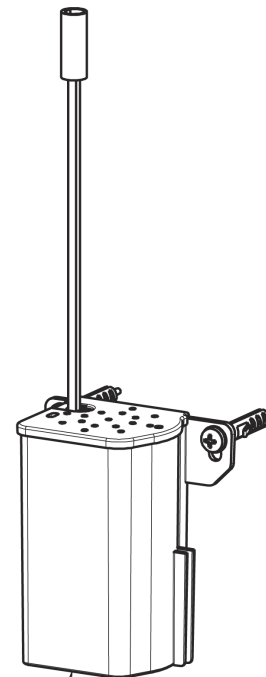

LONG LIFE  
BATTERY  
243.867.00.1

Electronic Module  
242.574.00.1

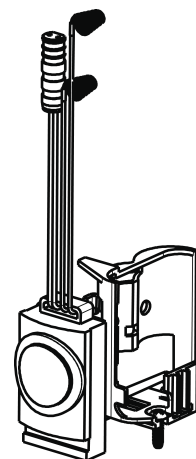

## For Technical Assistance:

Phone: 800-TEC-TRUE (832-8783)

Email: [techsupport.us@chicagofaucets.com](mailto:techsupport.us@chicagofaucets.com)

2100 South Clearwater Drive

Des Plaines, IL 60018

Phone: 847-803-5000

[chicagofaucets.com](http://chicagofaucets.com)