



a Geberit company

2100 South Clearwater Drive
Des Plaines, IL 60018
Phone: 847-803-5000
Fax: 847-803-5454
www.chicagofaucets.com

FOR TECHNICAL ASSISTANCE
1-800-TEC-TRUE (1-800-832-8783)

REPAIR PARTS

BY: JAR DATE: 01-20-12
CHK: *JAR* REV: 10-25-16

FITTING NO.
SEE SCHEDULE
SUBMITTED MODEL NO.
ITEM NO.

SCHEDULE	SCHEDULE
FITTING NO.	FITTING NO.
3501-E39VPABCP	3501-E2805ABCP
3501-4E39VPABCP	3501-4E2805ABCP
3501-8E39VPABCP	3501-8E2805ABCP

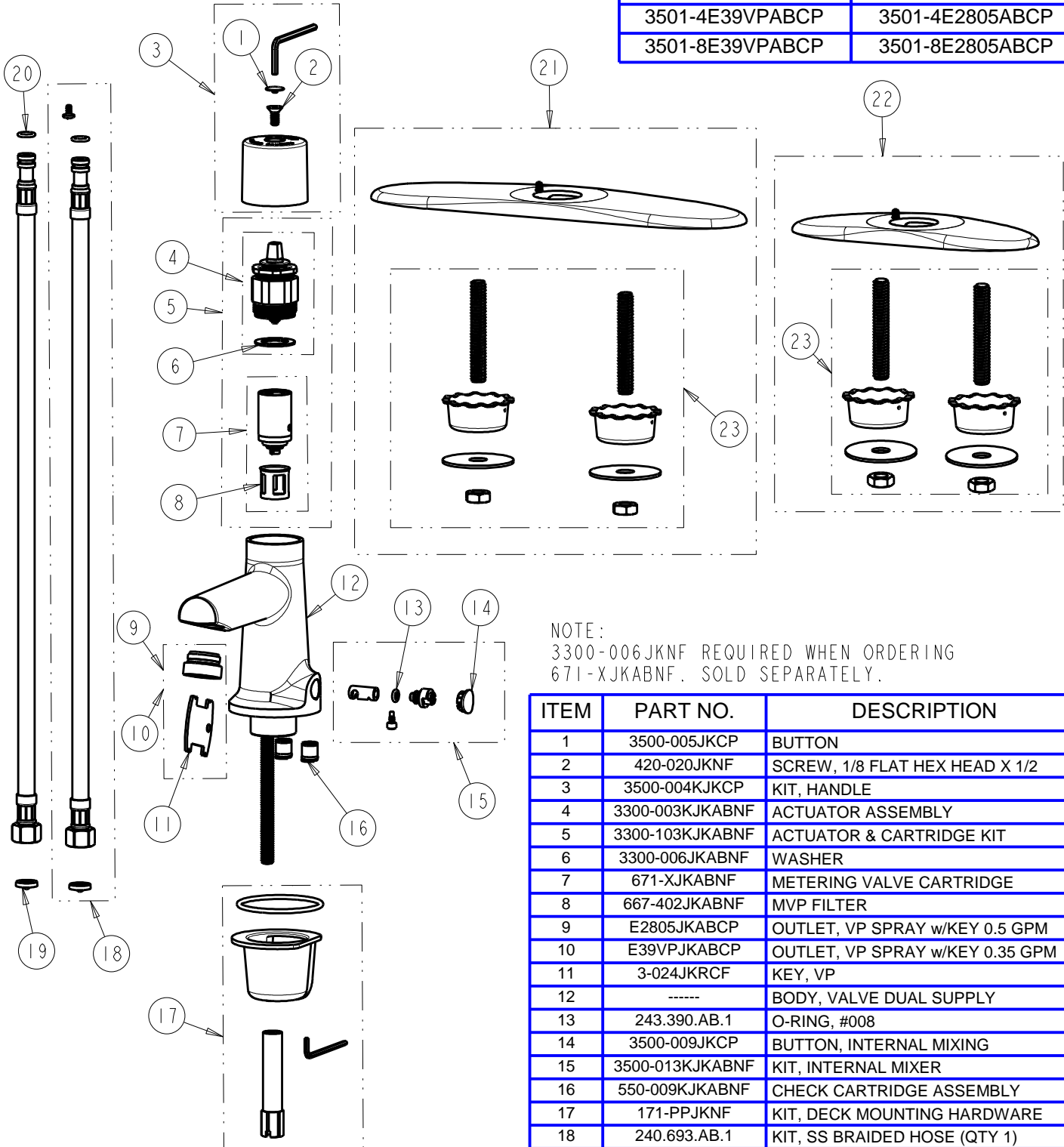

NOTE:
3300-006JKNF REQUIRED WHEN ORDERING
671-XJKABNF. SOLD SEPARATELY.

ITEM	PART NO.	DESCRIPTION
1	3500-005JKCP	BUTTON
2	420-020JKNF	SCREW, 1/8 FLAT HEX HEAD X 1/2
3	3500-004KJKCP	KIT, HANDLE
4	3300-003KJKABNF	ACTUATOR ASSEMBLY
5	3300-103KJKABNF	ACTUATOR & CARTRIDGE KIT
6	3300-006JKABNF	WASHER
7	671-XJKABNF	METERING VALVE CARTRIDGE
8	667-402JKABNF	MVP FILTER
9	E2805JKABCP	OUTLET, VP SPRAY w/KEY 0.5 GPM
10	E39VPJKABCP	OUTLET, VP SPRAY w/KEY 0.35 GPM
11	3-024JKRCF	KEY, VP
12	-----	BODY, VALVE DUAL SUPPLY
13	243.390.AB.1	O-RING, #008
14	3500-009JKCP	BUTTON, INTERNAL MIXING
15	3500-013KJKABNF	KIT, INTERNAL MIXER
16	550-009KJKABNF	CHECK CARTRIDGE ASSEMBLY
17	171-PPJKNF	KIT, DECK MOUNTING HARDWARE
18	240.693.AB.1	KIT, SS BRAIDED HOSE (QTY 1)
19	3300-005JKABNF	FILTER/SCREEN
20	243.392.AB.1	O-RING, #011
21	3500-002KJKCP	KIT, COVER PLATE 8 IN
22	3500-001KJKCP	KIT, COVER PLATE 4 IN
23	242.872.21.1	KIT, COVER PLATE MOUNTING