

CHICAGO FAUCETS 

a Geberit company

2100 South Clearwater Drive
Des Plaines, IL 60018
Phone: 847-803-5000
Fax: 847-803-5454
www.chicagofaucets.com

FOR TECHNICAL ASSISTANCE
1-800-TEC-TRUE (1-800-832-8783)

REPAIR PARTS

BY: JAR DATE: 01-18-12

CHK: *JAR* REV: 10-25-16

FITTING NO.

SEE SCHEDULE

SUBMITTED MODEL NO.

ITEM NO.

SCHEDULE

FITTING NO.

3500-E39VPABCP

3500-4E39VPABCP

3500-8E39VPABCP

SCHEDULE

FITTING NO.

3500-E2805ABCP

3500-4E2805ABCP

3500-8E2805ABCP

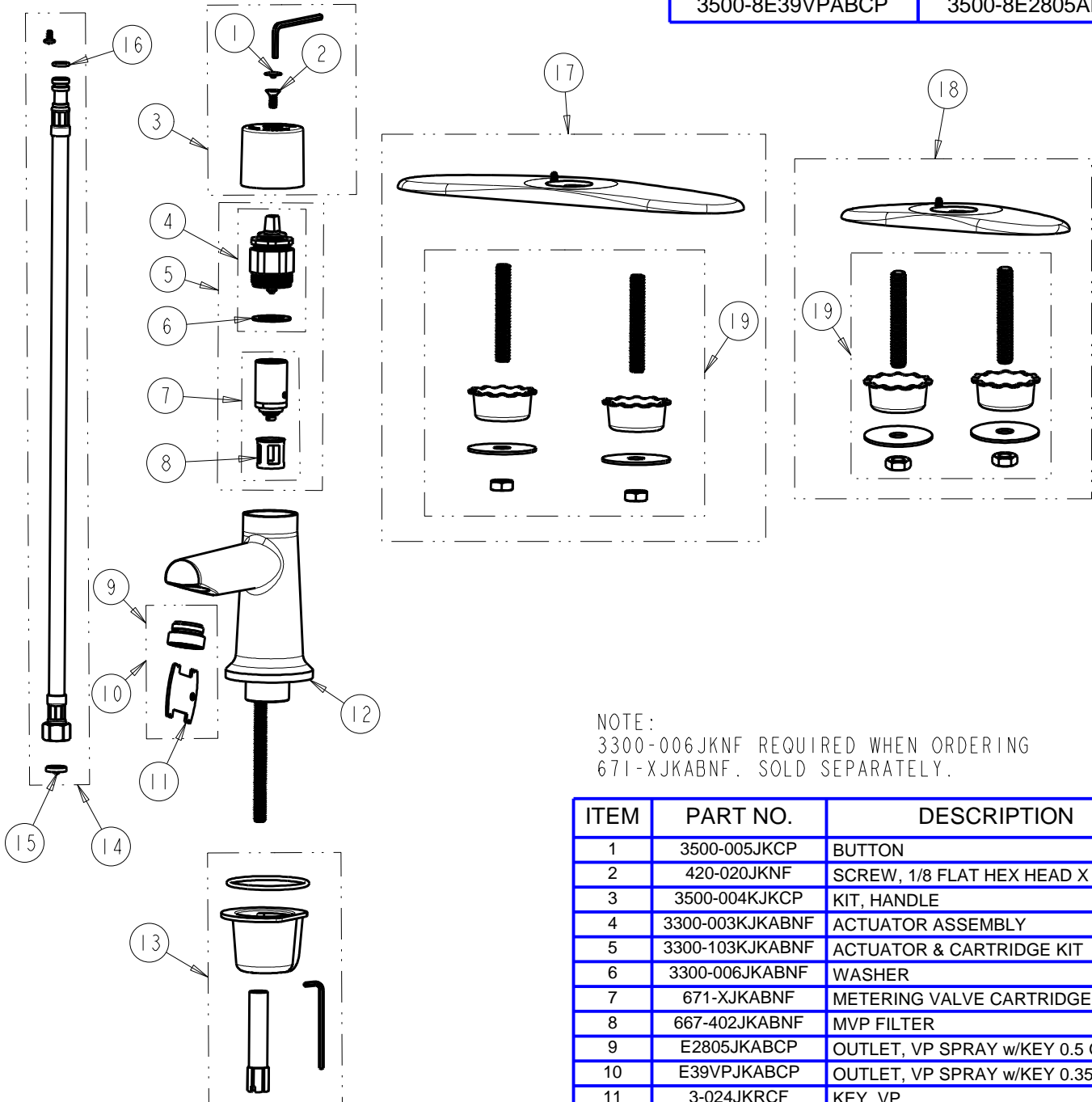

NOTE:
3300-006JKNF REQUIRED WHEN ORDERING
671-XJKABNF. SOLD SEPARATELY.

ITEM	PART NO.	DESCRIPTION
1	3500-005JKCP	BUTTON
2	420-020JKNF	SCREW, 1/8 FLAT HEX HEAD X 1/2
3	3500-004JKCP	KIT, HANDLE
4	3300-003JKABNF	ACTUATOR ASSEMBLY
5	3300-103JKABNF	ACTUATOR & CARTRIDGE KIT
6	3300-006JKABNF	WASHER
7	671-XJKABNF	METERING VALVE CARTRIDGE
8	667-402JKABNF	MVP FILTER
9	E2805JKABCP	OUTLET, VP SPRAY w/KEY 0.5 GPM
10	E39VPJKABCP	OUTLET, VP SPRAY w/KEY 0.35 GPM
11	3-024JKRCF	KEY, VP
12	-----	BODY, VALVE SINGLE SUPPLY
13	171-PPJKNF	KIT, DECK MOUNTING HARDWARE
14	240.693.AB.1	KIT, SS BRAIDED HOSE (QTY 1)
15	3300-005JKABNF	FILTER/SCREEN
16	243.392.AB.1	O-RING, #011
17	3500-002JKCP	KIT, COVER PLATE 8 IN
18	3500-001JKCP	KIT, COVER PLATE 4 IN
19	242.872.21.1	KIT, COVER PLATE MOUNTING